



****AVAILABLE SEPTEMBER 2025****

****FURNISHED**** Centrally located close to West Jesmond Metro Station, Sainsbury's Supermarket and the shops of Acorn Road, this is a great two bedroom lower 'Tyneside' style flat located on Bayswater Road, Jesmond. Boasting bright spacious rooms throughout and private outside space, this property is not to be missed!

Well presented throughout, the accommodation briefly comprises entrance porch through into hallway with a spacious cupboard for storage; master double bedroom to the front with bay window, electric fire and fitted wardrobes; second double bedroom with double bed & wardrobe; bright and airy lounge with wall mounted TV; modern fitted kitchen with tiled flooring and appliances; large family bathroom WC, fully tiled with three piece suite including electric shower. Externally there is a private south-facing rear yard, with space enough to park a small car via up and over garage door.

Available on a fully furnished basis, this property would be ideally for either a professional couple or professional sharers alike.

Available 23rd September 2025 | £1,200pcm |
Furnished | Ground Floor Tyneside Flat | 725 Sq
ft (67.3 m2) | Two Double Bedrooms | Lounge |
Modern Kitchen | Large Bathroom WC | South
Facing Rear Yard | Off Street Parking Space |
Great Central Location | Good Storage Space |
Council Tax Band: B | GCH & DG | EPC Rating:
D

£1,200 PCM



GROUND FLOOR
725 sq.ft. (67.3 sq.m.) approx.

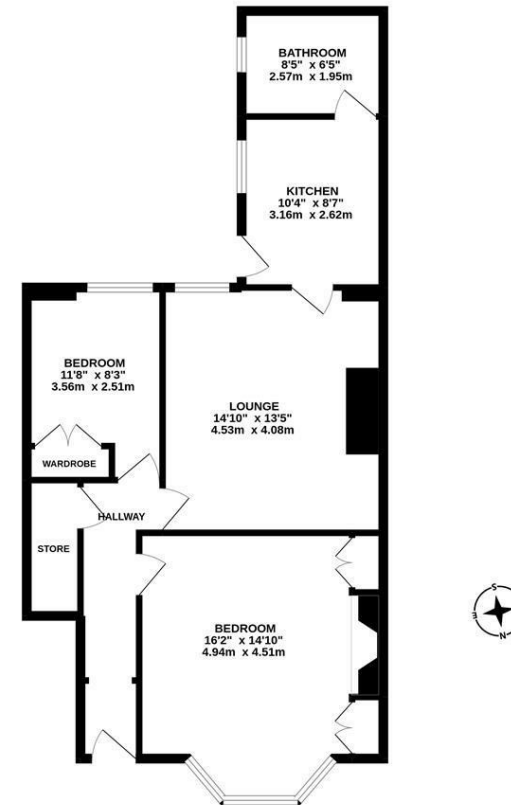

TOTAL FLOOR AREA: 725 sq.ft. (67.3 sq.m.) approx.

Whilst every attempt has been made to ensure the accuracy of the floorplan contained here, measurements of doors, windows, rooms and any other items are approximate and no responsibility is taken for any error, omission or misstatement. This plan is for illustrative purposes only and should be used as such by any prospective purchaser. The services, systems and appliances shown have not been tested and no guarantee as to their operability or efficiency can be given.
Made with Metropix ©2022

IMPORTANT NOTE: These particulars and the descriptions and measurements herein do not constitute representation and whilst every effort has been made to ensure accuracy, this cannot be guaranteed.

